

NEW

CURTAIN WALLS

SERIES HP3253 HIGH PERFORMANCE CURTAIN WALL



- 2-1/2" (63.5 mm) Face Dimension
- 2" (51 mm) Triple Pane Glazing
- U-Factors from 0.32 to 0.17 Using NFRC100
- Multiple System Depth
- Exterior Glazed
- Injection Molded Water Deflectors
- Three Thermal Break Points
- No Exposed Fasteners
- Vertically Butt Glazed Optional

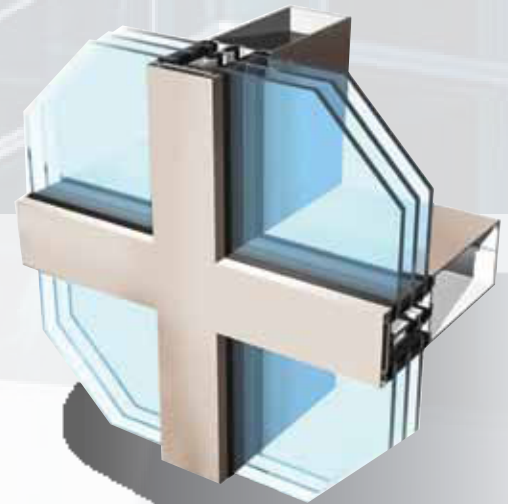

The Series HP3253 High Performance Curtain Wall System for 2" (51 mm) efficient triple-glazed infills, featuring Dual Thermal Break Technology utilizing the Poly-Aluminizer™ and Struct-Link™ Thermal break. Thermally isolated by a continuous thermal spacer and especially engineered to satisfy the increasing demands for energy conservation, a driven design from the beginning. Two-tone colors can be achieved by specifying different finishes for exterior face members and interior mullions. The system features stick erection with no exposed joint fasteners.

SERIES HP3253 TYPICAL DETAILS

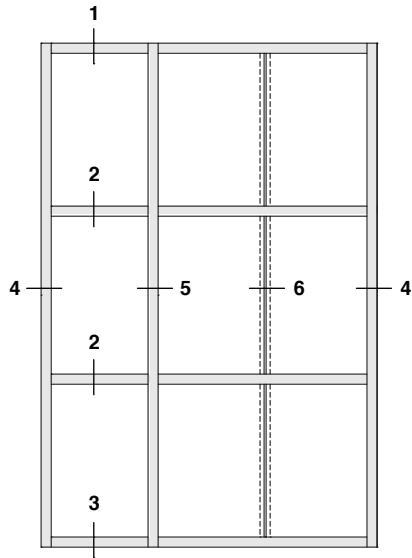

TYPICAL ELEVATION

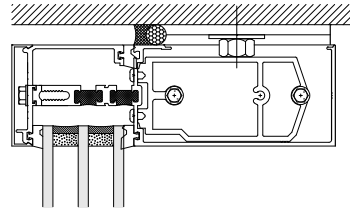

①
HEAD

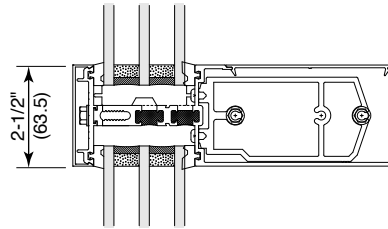

②
HOR ZONTAL

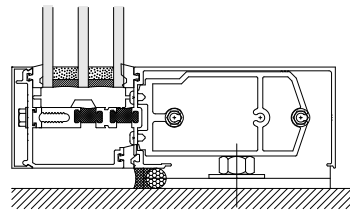

③
SILL

4", 5" (shown), and 8" Backmembers are available.

For Specifications, Details, and Testing Data go to usalum.com.

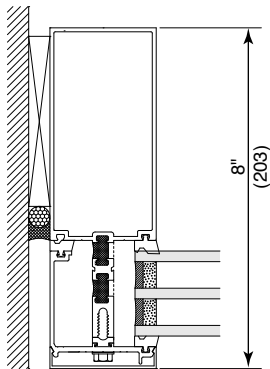

④
JAMB

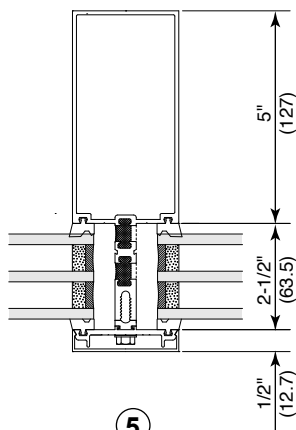

⑤
CAPTURED
VERT CAL

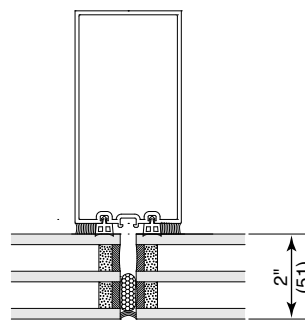

⑥
BUTT GLAZED
VERT CAL

NOT TO SCALE